

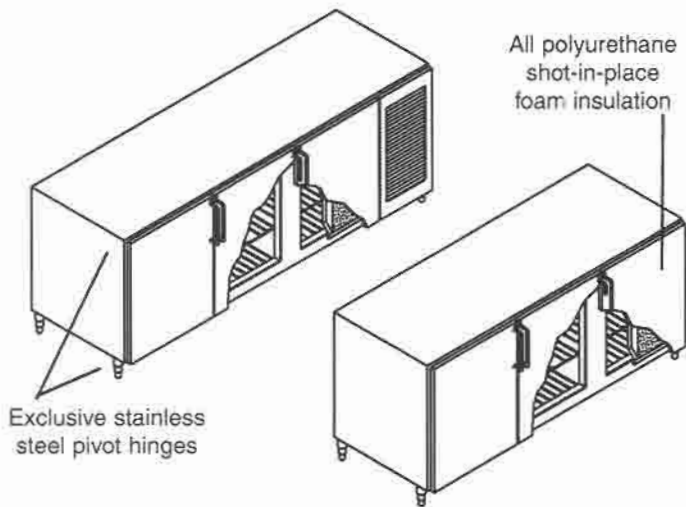

BBL MODELS

32" High Backbar Refrigerators & Dry Cabinets



OMNI EXCLUSIVE
SANITATION APPROVED
FOR OPEN FOOD
CONTAINERS - 1/2" RADIUS
INTERIOR CORNERS

PROJECT _____
 ITEM NO. _____
 QTY. _____

		REMOTE	SELF-CONTAINED	DRY STORAGE			
DOORS	MODEL	LENGTH	MODEL	LENGTH	MODEL	LENGTH	
<input type="checkbox"/>	1	BBLR-1	25-1/2"	BBLS-1	40-1/2"	DSL-1	25 1/2"
<input type="checkbox"/>	2	BBLR-2	48"	BBLS-2	63"	DSL-2	48"
<input type="checkbox"/>	3	BBLR-3	72"	BBLS-3	87"	N/A	N/A
<input type="checkbox"/>	4	BBLR-4	96"	BBLS-4	111"	N/A	N/A

Please specify door style when ordering by adding door style code to end of model number example: BBLS-4SD

FL- prepared for field laminated
 L- factory laminated
 SD- stainless steel
 GL- glass
 PC- powder coat enamel painted

STANDARD FEATURES

- **ALL WELDED CONSTRUCTION**
- **TOP** - 18 gauge galvanized sub-top.
- **EXTERIOR FRONT & SIDES & INTERIOR** - 20 gauge #304 s/s stainless steel. Back and bottom are 18 gauge galvanized.
- **DOOR PAN** - 20 gauge #304 18-8 s/s with magnetic gasket.
- **DOOR HARDWARE** - Exclusive heavy-duty 12 gauge stainless steel pivot hinges with attractive chrome door pull and locks.
- **INSULATION** - 2" thick polyurethane shot-in-place foam (NO CFC's)
- **BREAKER STRIP** - Exclusive Foam-Locked breaker strip permanently installed without mechanical fasteners.
- **SHELVING** - Each door section includes two adjustable, vinyl coated wire shelves.
- **SELF-CONTAINED REFRIGERATION** - fully balanced hermetic condensing unit is provided with evaporator coil, TX valve, thermostat, gravity defrost system and condensate evaporator.
- **REMOTE MODELS** - include all of the above with the exception of condensing unit and condensate evaporator pan. Expansion valve shipped loose. No pre-wiring.
- **INTERIOR LIGHTS** - Option bulb type L.

OPTIONS

- STP** -----finished 18 gauge s/s top
- 6LG** -----6" x 1-5/8" stainless steel legs with adjustable bullet feet
- CST** -----casters
- TK** -----stainless steel toe kick plate
- SSS** -----stainless steel wire shelves
- AS** -----all stainless steel construction
- BH** -----brass hardware
- F** -----freezer
- RCND** -----remote condensing unit
- EVP** -----condensate evaporator (remote only)
- DT** -----dual temp
- M** -----customized
- PP** -----Pre-piped & pre-wired. Refrigeration, plumbing and electrical will be stubbed out at required location by specifying one of the following: LE-left end, RE-right end, BL-back left, BR-back right.

Model Number Guide

Use this guide to create the model specific to your needs.

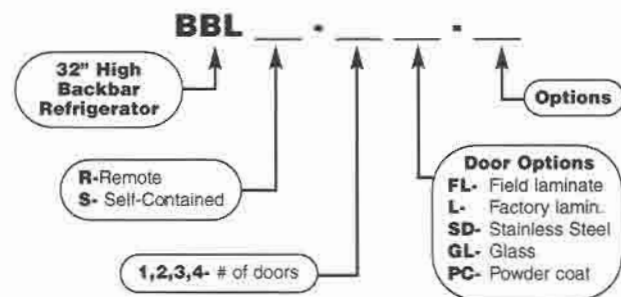



BBL MODELS

32" High Backbar Refrigerators & Dry Cabinets

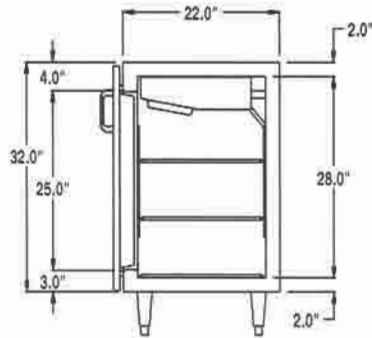

SECTION

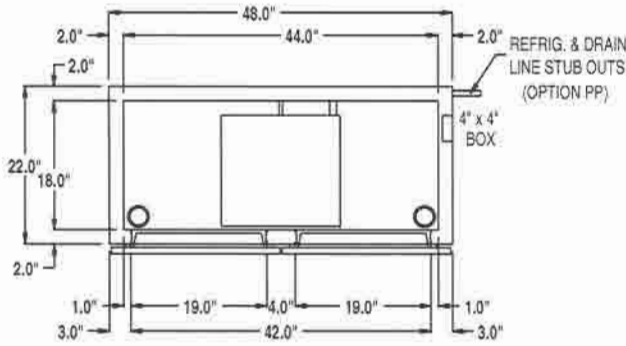

BBLR-2

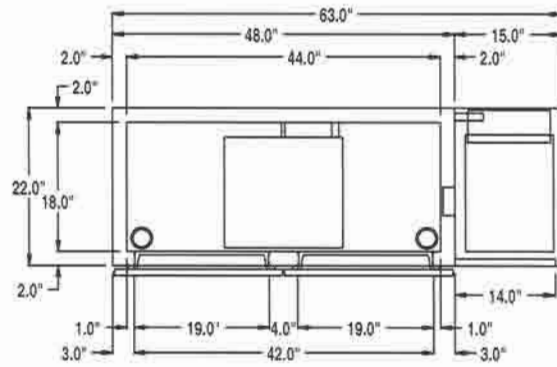

BBLR-2

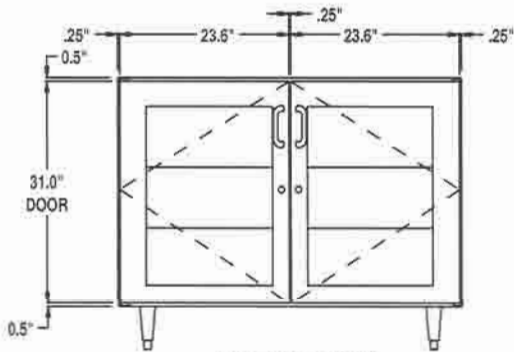

ELEVATION

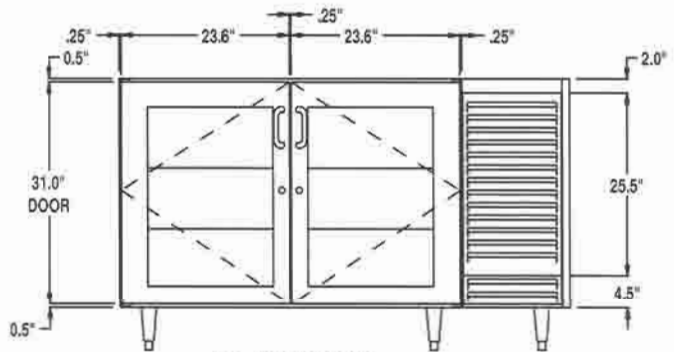

ELEVATION

MODEL	DOOR	O.A. CABINET DIMENSIONS			COMPRS.	ELECTRICAL			SHIP		
	SECTIONS	LENGTH	DEPTH	HEIGHT	HP.	AMPS	VOLTAGE	PHASE	BTUs	WEIGHT	CUBE
BBLR-1	1	25-1/2"	24"	32"	—	1.3	115v	SINGLE	1000	234	25
BBLR-2	2	48"	24"	32"	—	1.7	115v	SINGLE	1300	375	37
BBLR-3	3	72"	24"	32"	—	2.3	115v	SINGLE	1700	475	51
BBLR-4	4	96"	24"	32"	—	3.7	115v	SINGLE	2300	632	66
BBLR-1	1	40-1/2"	24"	32"	1/4	9.1	115v	SINGLE	—	342	25
BBLR-2	2	63"	24"	32"	1/4	11	115v	SINGLE	—	460	37
BBLR-3	3	87"	24"	32"	1/3	13.9	115v	SINGLE	—	671	51
BBLR-4	4	111"	24"	32"	1/3	13.9	115v	SINGLE	—	748	66
DSL-1	1	25-1/2"	24"	32"	—	—	—	—	—	154	25
DSL-2	2	48"	24"	32"	—	—	—	—	—	278	37

DRY SELF CONT. REMOTE

NOTE: If using glass doors, add 200 BTUs per door