

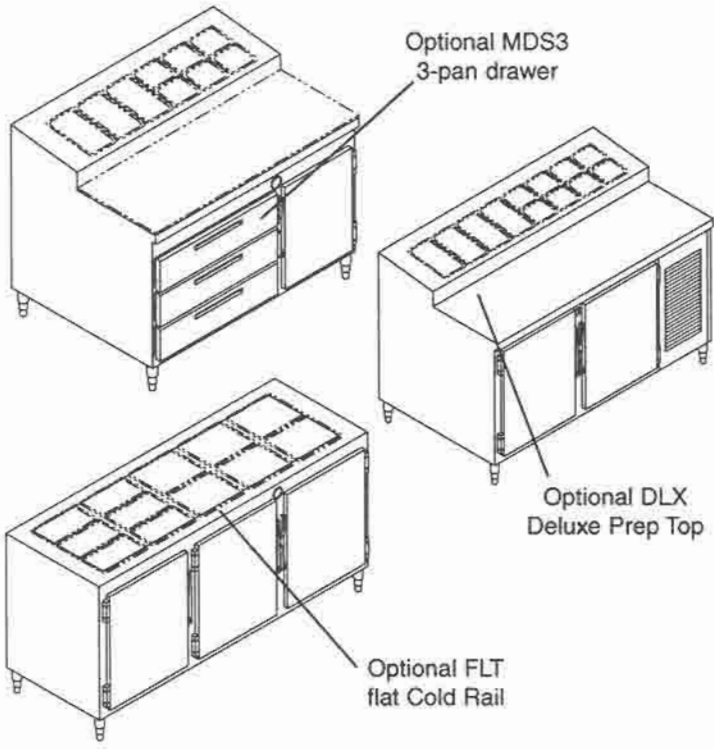

Preparation Refrigerators

NSF7 Listed Cold Rails



PROJECT _____
 ITEM NO. _____
 QTY. _____
 MODEL NO. _____

Integrating to custom-fabricated counter - preparation refrigerators can be ordered with sub top only for integrating into custom fabricated counters. Fabricator will be supplied with a detailed shop drawing which will illustrate how to fabricate counter top.

OPTIONS

- DLX** —Deluxe Prep Top. 14 gauge #304 18-8 stainless steel with raised rail, slightly sloped to front and 1" thick white polyethylene cutting board.
- (02)** —two drawer high section (see model guide).
- MDS3** —exclusive three-pan drawers
- 6LG** —6" x 1-5/8" stainless steel legs with adjustable bullet feet
- CST** —casters
- SBK** —stainless steel back
- AS** —all stainless steel construction
- PS** —pan slides
- F** —freezer
- DT** —dual temp
- FLT** —flat Cold Rail (in lieu of sloped)
- M** —customized
- PP** —Pre-piped & pre-wired. Refrigeration, plumbing and electrical will be stubbed out at required location by specifying one of the following: LE-left end, RE-right end, BL-back left, BR-back right.

STANDARD FEATURES

- **ALL WELDED CONSTRUCTION**
- **TOP** - 18 gauge galvanized sub-top with raised rail, with exclusive NSF-7 Penguin Rail pan chiller system, which holds 1/3, 1/2, or full-size pans.
- **EXTERIOR FRONT & SIDES & INTERIOR** - 20 gauge #304 s/s stainless steel. Back and bottom are 18 gauge galvanized.
- **DOORS** - 18 gauge front and 20 gauge door pan #304 18-8 stainless steel with polyurethane shot-in-place foam insulation. Non-magnetic, high compression, long life vinyl gasket. Kason edge mount self-closing hinges and locking door latch.
- **INSULATION** - 2" thick polyurethane shot-in-place foam (NO CFC's)
- **BREAKER STRIP** - Exclusive Foam-Locked breaker strip permanently installed without mechanical fasteners.
- **SHELVING** - Two adjustable, vinyl coated wire racks per door section.
- **SELF-CONTAINED REFRIGERATION** - fully balanced hermetic condensing unit is provided for both the refrigerated base and pan chiller. Pan chiller includes TX valve, solenoid valve and defrost time clock. Evaporator coil includes TX valve, thermostat and solenoid valve. Condensate evaporator also provided. Condensing unit on right unless otherwise specified.
- **REMOTE MODELS** - include all of the above with the exception of condensing unit and condensate evaporator pan. Expansion valve shipped loose. No pre-wiring.
- **DIAL THERMOMETER**
- **INTERIOR LIGHTS** - Option bulb type L.

Model Number Guide

Use this guide to create the model specific to your needs.

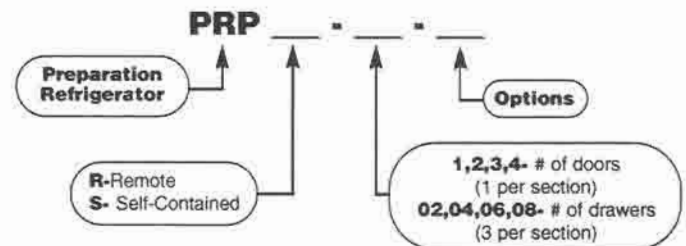



PRP MODELS

Preparation Refrigerators

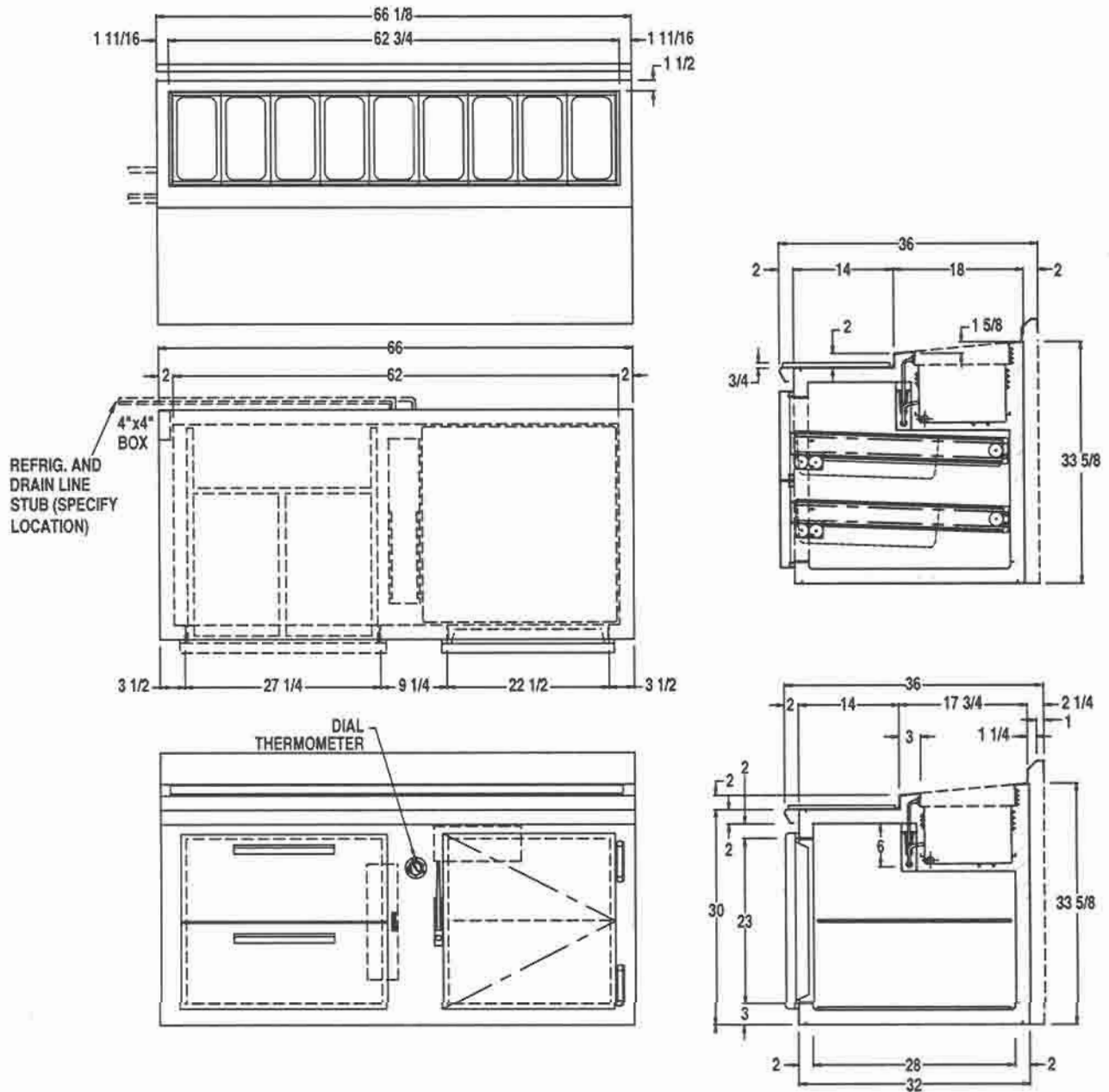

NOTE: Contact Factory for drawings. Many custom models available.