

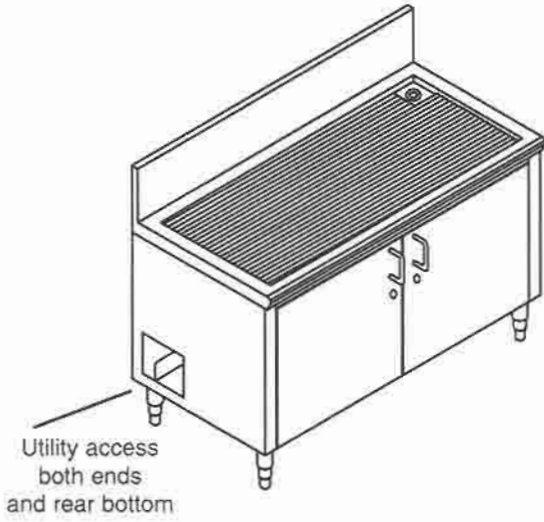

# LIHC MODELS

## Liquor Intelligence Housing

with Drainboard Top



PROJECT \_\_\_\_\_

ITEM NO. \_\_\_\_\_

QTY. \_\_\_\_\_

For housing liquor  
dispensing system  
components access  
chases ends and  
rear bottom

	MODEL	LENGTH	DEPTH
<input type="checkbox"/>	LIHC-18	18"	24"
<input type="checkbox"/>	LIHC-24	24"	24"
<input type="checkbox"/>	LIHC-36	36"	24"
<input type="checkbox"/>	LIHC-48	48"	24"

### STANDARD FEATURES

- **INTERIOR** - 3/4" marine plywood laminated with sanitation approved Kortron surface, mounted to interior back and ends for easily affixing liquor system components.
- **ACCESS PANELS** - located at each end and bottom of cabinet.
- **HINGED DOORS** - provided with extra heavy duty locking hasp.
- **ALL WELDED CONSTRUCTION** - fully welded, ground and polished to form one integral unit; no screws, pop-rivets or solder.
- **CORRUGATION** - 18 gauge #304 series 18-8 stainless steel full-length continuous "WWW" corrugation pitches to 1" brass drain and is reinforced with 4" wide 14 gauge s/s inverted U-channels welded underneath and sound deadened.
- **TOP** - 18 gauge #304 series 18-8 stainless steel.
- **BACK** - 18 gauge #304 series 18-8 stainless steel.
- **BOTTOM** - 18 gauge #304 series 18-8 stainless steel.
- **ENDS** - 18 gauge #304 series 18-8 stainless steel.
- **BACKSPASH** - 18 gauge #304 series 18-8 stainless steel.
- **LEG ASSEMBLIES** - 14 gauge s/s channels with heavy-duty s/s gussets, 1-5/8" s/s tube legs and adjustable s/s bullet feet.
- **DECORATIVE POLISHED BULLNOSE**

### OPTIONS

- M -----customized

### Model Number Guide

Use this guide to create the model specific to your needs.

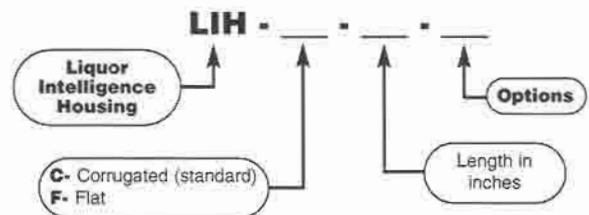



**LIHC MODELS**

*Liquor Intelligence Housing*

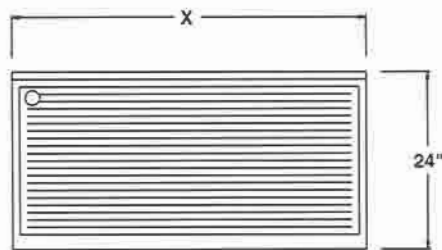

PLAN VIEW

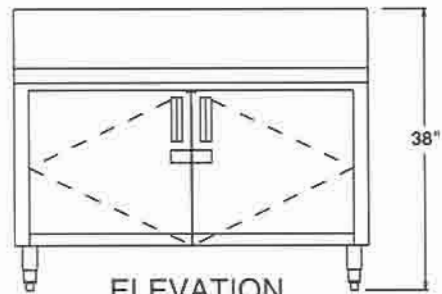

ELEVATION

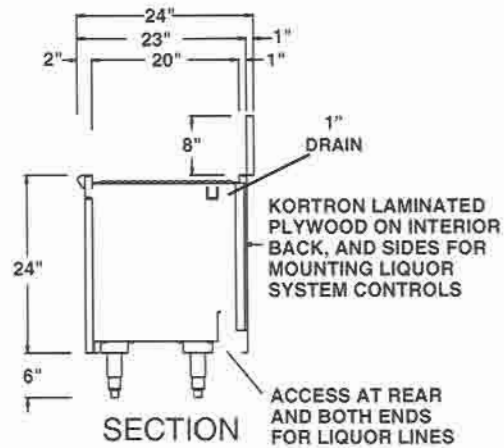

SECTION

MODEL	LENGTH	DEPTH	HEIGHT	SHIP WEIGHT	CUBE
LIHC-18	18"	24"	30"	140	8
LIHC-24	24"	24"	30"	175	14
LIHC-36	36"	24"	30"	220	20
LIHC-48	48"	24"	30"	255	26