



PT MODELS

Pass-Thru Ice Chest

with 8 circuit cold plate

PROJECT _____
 ITEM NO. _____
 QTY. _____

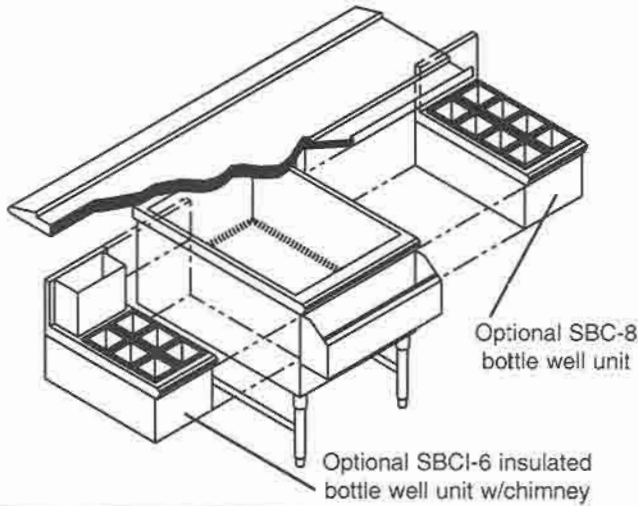

"S" SERIES (36" DEEP)

	MODEL	LENGTH	DEPTH	ICE CAP.
<input type="checkbox"/>	SPT-24P8	24"	36"	150
<input type="checkbox"/>	SPT-30P8	30"	36"	168

"D" SERIES (40" DEEP)

	MODEL	LENGTH	DEPTH	ICE CAP.
<input type="checkbox"/>	DPT-24P8	24"	40"	168
<input type="checkbox"/>	DPT-30P8	30"	40"	210

For Pass-Thru less Cold Plate, drop P8 from end of model number, ex: PT-48

STANDARD FEATURES

- **ALL WELDED CONSTRUCTION** - fully welded, ground and polished to form one integral unit; no screws, pop-rivets or solder.
- **TOP** - 18 gauge #304 series 18-8 stainless steel.
- **FRONT & BACK APRONS** - 18 gauge #304 series 18-8 s/s.
- **BACK** - 18 gauge #304 series 18-8 stainless steel.
- **BOTTOM** - 18 gauge #304 series 18-8 stainless steel.
- **ENDS** - 18 gauge #304 series 18-8 stainless steel.
- **BACKSPLASH** - 18 gauge #304 series 18-8 stainless steel.
- **ICE CHEST LINER** - 12-1/2" net deep, 18 gauge #304 series 18-8 stainless steel all welded with 3/8" radius corners.
- **8 CIRCUIT FAST-FLO SEALED-IN COLD PLATE**
- **INSULATION** - polyurethane shot-in-place foam (NO CFC's).
- **DECORATIVE POLISHED BULLNOSE** - on bartender and waitress side.

OPTIONS

- CB** -----full cabinet base with removable hinged doors
- 18X** -----18" deep ice chest
- P10** -----10 circuit cold plate
- P12** -----12 circuit cold plate
- DRP** -----drop-down waitress side
- CR-#**-----condiment rail (specify # of pans)
- IP**-----ice partition
- SBC-3**-----3 bottle well unit
- SBC-4**-----4 bottle well unit
- SBC-6**-----6 bottle well unit
- SBC-8**-----8 bottle well unit
- SBCI-6C** --insulated 6 bottle well unit w/ chimney
- SBCI-3C** --insulated 3 bottle well unit w/ chimney
- PRF** -----perforated bottom plate (only in non-cold plate units)
- M** -----customized

Model Number Guide

Use this guide to create the model specific to your needs.

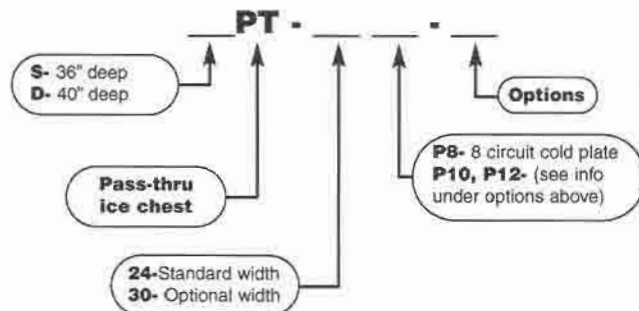



PT MODELS

Pass-Thru Ice Chest

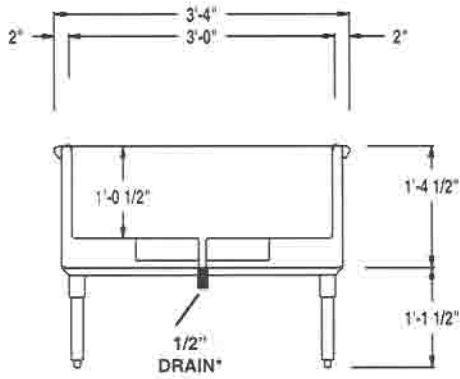

"D" SECTION

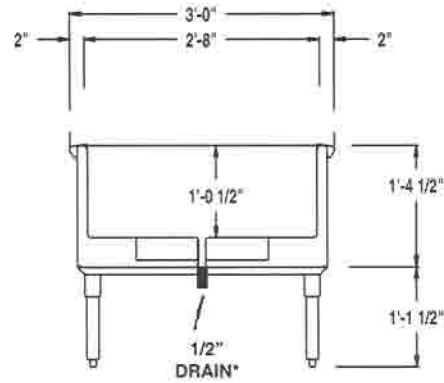

"S" SECTION

*NOTE: MODELS WITHOUT COLD PLATE USE 1" DRAIN

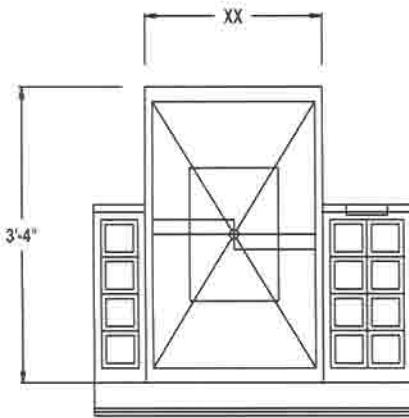

"D" PLAN

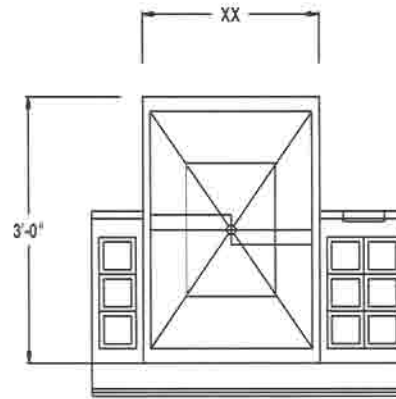

"S" PLAN

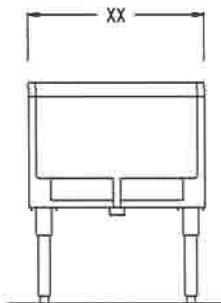

ELEVATION

"S" SERIES (36" DEEP)

MODEL NUMBER	O.A. LENGTH	O.A. DEPTH	ICE CAP.	SHIP WEIGHT	CUBE
SPT-24P8	24"	36"	150	255	28
SPT-30P8	30"	36"	168	295	32

"D" SERIES (40" DEEP)

MODEL NUMBER	O.A. LENGTH	O.A. DEPTH	ICE CAP.	SHIP WEIGHT	CUBE
DPT-24P8	24"	40"	168	255	28
DPT-30P8	30"	40"	210	295	32