

VL SERIES

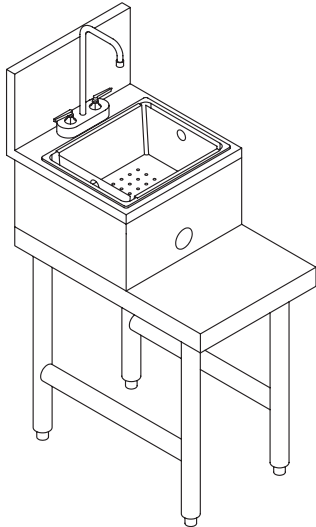

BS MODELS

Recessed Blender Stations



with rectangular sink and H/C faucet

PROJECT _____

ITEM NO. _____

QTY. _____

MODEL NO. _____

For Blender Station less Sink, drop S after B in model number, ex: DB-14

"S" SERIES

	LINE	MODEL	LENGTH	DEPTH	SINK
<input type="checkbox"/>	VL	SBS-12	12"	25"	9" x 11" x 6" DEEP
<input type="checkbox"/>	VL	SBS-14	14"	23"	9" x 11" x 6" DEEP
<input type="checkbox"/>	VL	SBS-18	18"	23"	9" x 11" x 6" DEEP

"D" SERIES

	LINE	MODEL	LENGTH	DEPTH	SINK
<input type="checkbox"/>	VL	DBS-12	12"	26-1/2"	9" x 11" x 6" DEEP
<input type="checkbox"/>	VL	DBS-14	14"	26-1/2"	9" x 11" x 6" DEEP
<input type="checkbox"/>	VL	DBS-18	18"	26-1/2"	9" x 11" x 6" DEEP

STANDARD FEATURES

- **ALL WELDED CONSTRUCTION** - fully welded, ground and polished to form one integral unit; no screws, pop-rivets or solder.
- **CORRUGATION** - 20 gauge #304 series stainless steel full-length continuous "WWW" corrugation pitches to 1" brass drain.
- **FRONT APRON** - 20 ga. #304 series, stainless steel.
- **BLENDER SHELF** - 20 ga. #304 series, stainless steel with hidden electrical outlet mounted underneath.
- **FAUCET** - Quality hot/cold faucet
- **BACK** 20 ga. #304 series, stainless steel.
- **BOTTOM** 20 ga. #304 series, stainless steel.
- **ENDS** 20 ga. #304 series, stainless steel.
- **BACKSPLASH** - 20 ga. #304 series, stainless steel.
- **LEG ASSEMBLIES** - 14 gauge s/s channels with 1-5/8" s/s tube legs and adjustable s/s bullet feet.

Model Number Guide

Use this guide to create the model specific to your needs.

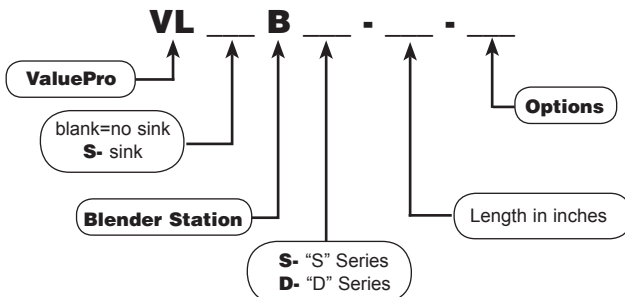

OPTIONS

- CB----- full cabinet base with removable hinged doors
- PDB----- perforated dump box
- PR----- pre-rinse spray faucet (includes installed sleeve in top)
- CRB----- carbonator shelf under
- M----- customized



CONFORMS TO ANSI/NSF STANDARD 2

VL SERIES



BS MODELS

Recessed Blender Stations

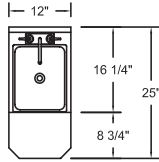

S-SERIES PLAN

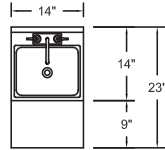

S-SERIES PLAN

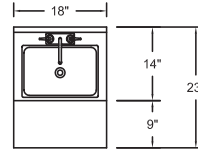

S-SERIES PLAN

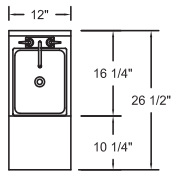

D-SERIES PLAN

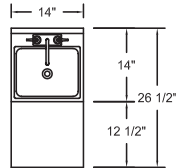

D-SERIES PLAN

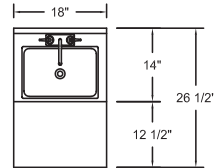

D-SERIES PLAN

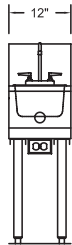

ELEVATION



ELEVATION

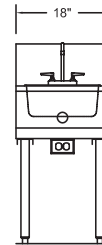

ELEVATION

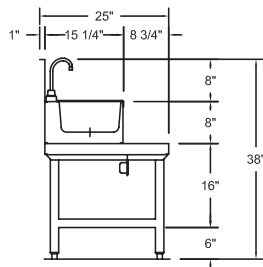

12" S-SERIES SECTION

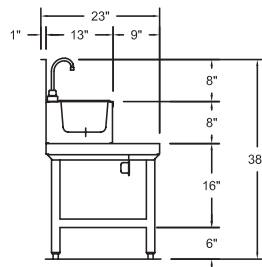

S-SERIES SECTION

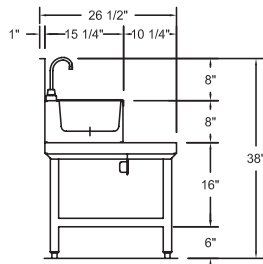

12" D-SERIES SECTION

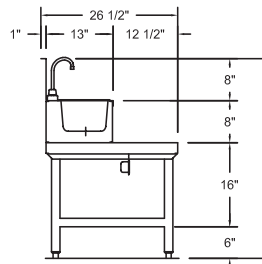

D-SERIES SECTION