

VL SERIES

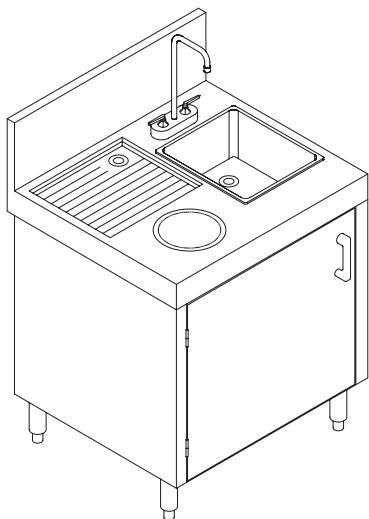

GWS MODELS

Soiled Glass Wash Centers



PROJECT _____
 ITEM NO. _____
 QTY. _____
 MODEL NO. _____

SOILED GLASS CENTER

	LINE	MODEL	LENGTH	SINK SIZE
<input type="checkbox"/>	VL	GWS-26	23"	9" x 11" x 6" DEEP

OPTIONS

- PR----- hot spray pre-rinse faucet
- M----- customized

STANDARD FEATURES

- **ALL WELDED CONSTRUCTION** - fully welded, ground and polished to form one integral unit; no screws, pop-rivets or solder.
- **CORRUGATION** - 18 gauge #304 series stainless steel full-length continuous "WWW" corrugation pitches to 1" brass drain.
- **TOP** - 18 ga. #304 series, stainless steel.
- **BACK** 20 ga. #304 series, stainless steel.
- **BOTTOM** 20 ga. #304 series, stainless steel.
- **ENDS** 20 ga. #304 series, stainless steel.
- **BACKSPLASH** - 18 ga. #304 series, stainless steel.
- **LEG ASSEMBLIES** - 14 gauge s/s channels with 1-5/8" s/s tube legs and adjustable s/s bullet feet.
- Dump sink with strainer basket and faucet.
- 6" diameter waste chute, with hinged door and plastic waste receptacle.

Model Number Guide

Use this guide to create the model specific to your needs.

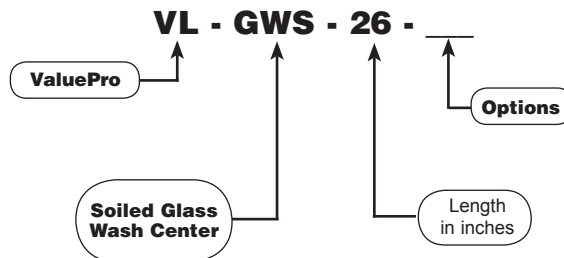

CONFORMS TO ANSI/NSF STANDARD 2

VL SERIES



GWS MODELS

Soiled Glass Wash Centers

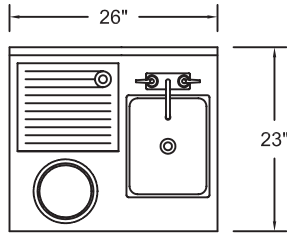

PLAN

VL-GWS-26

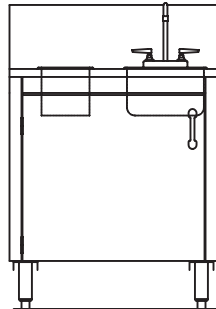

ELEVATION

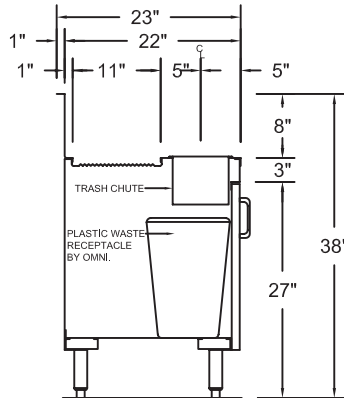

SECTION

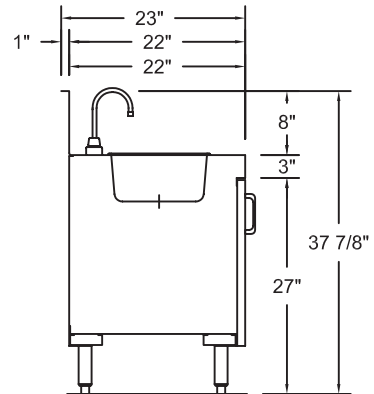

SECTION